

**Application with plug seal**

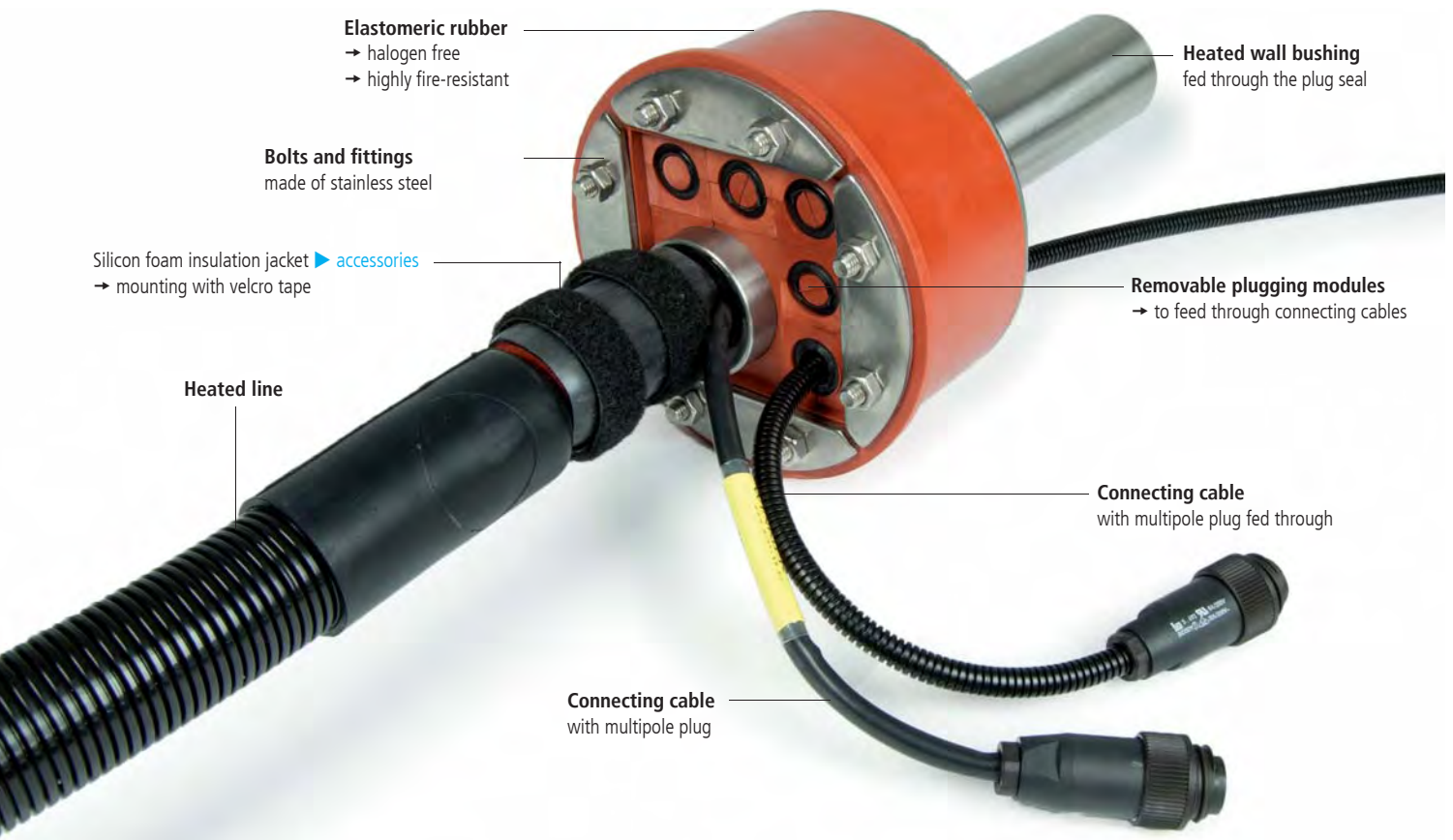

**Applications**

On engine test beds or roller dynamometer test beds to channel measuring gases to the analyzer-room securely and according to norms.

**Benefits**

- Rugged design made of high-quality materials.
- The system is engineered for permanent operating temperatures up to 200°C.
- Continuous heating without cold spots

**Models**

- Nominal diameter (=inner diameter of the heated passages) standard DN 4 and 6 others upon request.
- Length L (corresponds to wall thickness): 200 mm, 250 mm and 300 mm or any other according to customer specification
- Operating voltage: standard 230 VAC, other operating voltages upon request
- Sensor: standard Pt 100 or thermocouples type K or type J, other sensors upon request.

**Technical Datas**

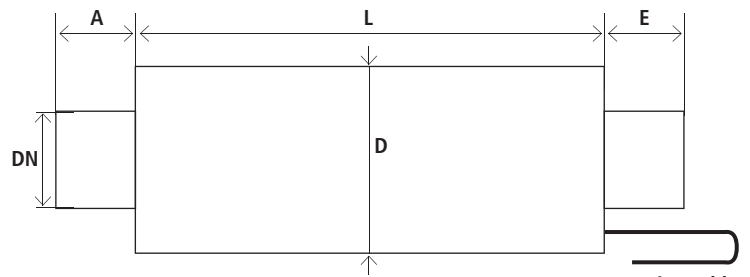

**A:** Overhang (A-side)

**E:** Overhang electric connection side (E-side)

**L:** Length (= wall thickness)

**DN:** Nominal diameter

**D:** Outer diameter

**ACCESSORIES**



**Insulation jacket**  
Art.-Nr. **WAZX102**



**Temperature controller for wall installation**  
Art.-Nr. **WRW00110-230XP000** (for sensor Pt 100)  
Art.-Nr. **WRW00110-230XK000** (for sensor type K)  
Art.-Nr. **WRW00110-230XJ000** (for sensor type J)

**Heated wall bushing** made of stainless steel, sealed with silicone

	<p><b>A:</b> Overhang (A-side)</p>	<p>25 mm or acc. to customer specification</p>
	<p><b>E:</b> Overhang electric connection side (E-side)</p>	<p>25 mm or acc. to customer specification</p>
	<p><b>L:</b> Length (= wall thickness)</p>	<p>250, 300, 350 mm or acc. to customer specification</p>
	<p><b>DN:</b> Nominal diameter</p>	<p>4 (6 x 1 mm); 6 (8 x 1 mm); 8 (10 x 1 mm); 10 (12 x 1 mm)</p>
	<p><b>D:</b> Outer diameter</p>	<p>54 mm</p>
	<p>Core hole bore</p>	<p>60 mm</p>
	<p><b>A:</b> Overhang (A-side)</p>	<p>100 mm or acc. to customer specification</p>
	<p><b>E:</b> Overhang electric connection side (E-side)</p>	<p>100 mm or acc. to customer specification</p>
	<p><b>L:</b> Length (= wall thickness)</p>	<p>or acc. to customer specification</p>
	<p><b>DN:</b> Nominal diameter</p>	<p>80 (88,9 x 2 mm)</p>
	<p><b>D:</b> Outer diameter</p>	<p>154 mm</p>
	<p>Core hole bore</p>	<p>160 mm</p>
	<p><b>A:</b> Overhang (A-side)</p>	<p>100 mm or acc. to customer specification</p>
	<p><b>E:</b> Overhang electric connection side (E-side)</p>	<p>100 mm or acc. to customer specification</p>
	<p><b>L:</b> Length (= wall thickness)</p>	<p>or acc. to customer specification</p>
	<p><b>DN:</b> Nominal diameter</p>	<p>150 (154 x 2 mm)</p>
	<p><b>D:</b> Outer diameter</p>	<p>204 mm</p>
	<p>Core hole bore</p>	<p>210 mm</p>
	<p><b>A:</b> Overhang (A-side)</p>	<p>100 mm or acc. to customer specification</p>
	<p><b>E:</b> Overhang electric connection side (E-side)</p>	<p>100 mm or acc. to customer specification</p>
	<p><b>L:</b> Length (= wall thickness)</p>	<p>or acc. to customer specification</p>
	<p><b>DN:</b> Nominal diameter</p>	<p>200 (204 x 2 mm)</p>
	<p><b>D:</b> Outer diameter</p>	<p>254 mm</p>
	<p>Core hole bore</p>	<p>260 mm</p>